

P 22/32 - PR 32
TM-TMP 32 - TMP 42
ENTERPRISE

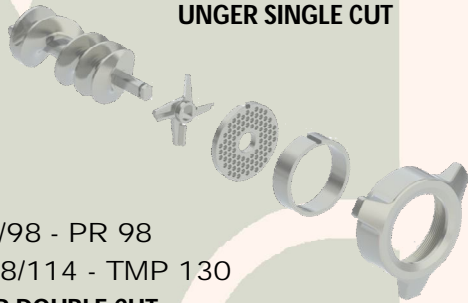

TM-TMP 98
UNGER SINGLE CUT



P 82/98 - PR 98
TM-TMP 98/114 - TMP 130
UNGER DOUBLE CUT

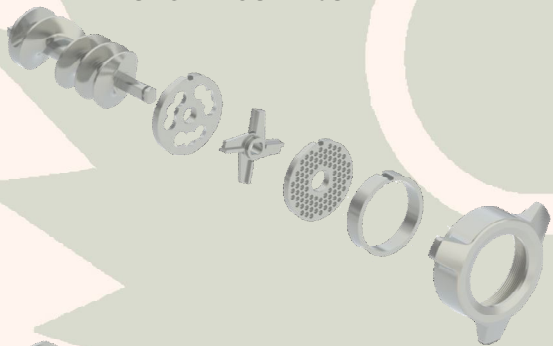

TM-TMP 98/114 - TMP 130
UNGER TRIPLE CUT



TMP 42 / 130

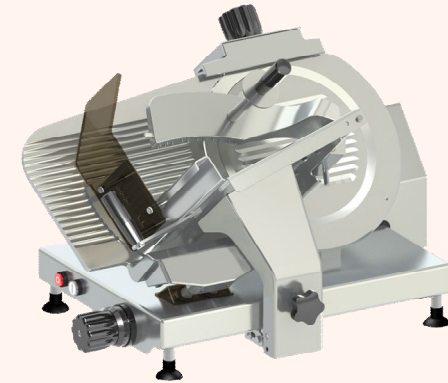

BRAHER INTERNACIONAL, S.A.

Carlos I, 14-1° C
☎ : +34-943 470 121
Fax: +34-943 470 245
Aptdo. 382 – 20080 SAN SEBASTIAN (SPAIN)
e-mail: braher@braher.com www.braher.com



TMP 32 / 98 / 114 / 42 / 130

TM 32 / 98
Pedestal

P 22 / 82 - 32 / 98

PR 32 / 98

TM 32 / 98 / 114

MOD.	Tray		Production	
	Ltr.	Lbs	Kg / h	Lbs / min
P 22 / 82	9	20	250 - 300	9 - 11
P 32 / 92	9	20	400 - 450	15 - 17
PR 32 / 98	8	18	400 - 450	15 - 17
TM 32 / 98	15	33	750	28
TM 114	20	44	1.100	40
TMP 32 / 98	60	132	750	28
TMP 114	60	132	1.100	40
TMP 42 / 130	80	176	1.500	55

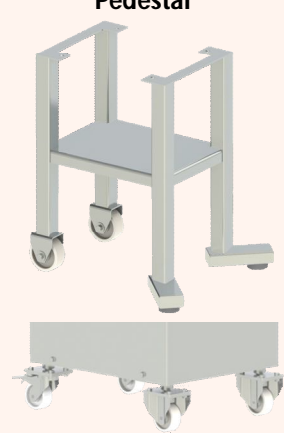

TMP
Wheels

MOD.	Cutting capacity			
	Máx. ∇		Máx. \emptyset	
	mm.	in	mm.	in
USA-250	270 x 140	10,63 x 5,51	170	6,69
USA-280	270 x 145	10,63 x 5,71	185	7,28
USA-300	270 x 155	10,63 x 6,10	200	7,87
USA-350	285 x 180	11,22 x 7,09	220	8,66
MG-300	265 x 160	10,43 x 6,30	195	7,68
MG-350	305 x 205	12,01 x 8,07	250	9,84
MA-300	265 x 160	10,43 x 6,30	195	7,68
MA-350	305 x 205	12,01 x 8,07	250	9,84

USA 250 - 280 - 300 - 350



MG 300 - 350 (Crown drive)

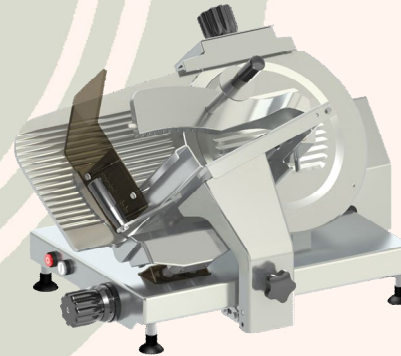

MA 300 - 350 (Crown drive)

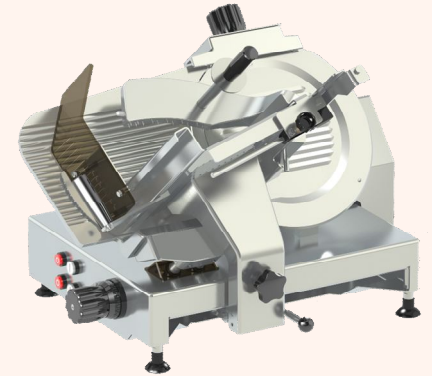

05 / 2015

MG - MA
Blade removal

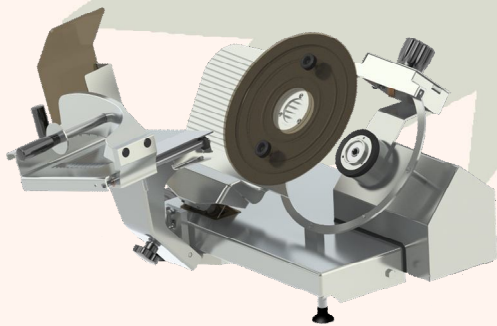

MG - MA
Water cleaning

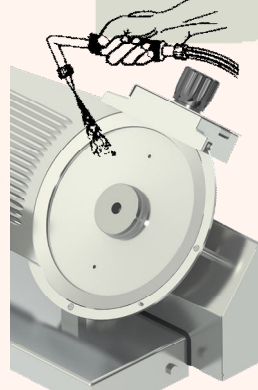

MG - MA
Oiler

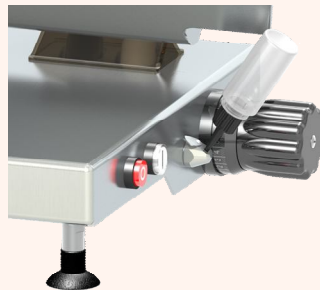

MG - MA
Extended carriage

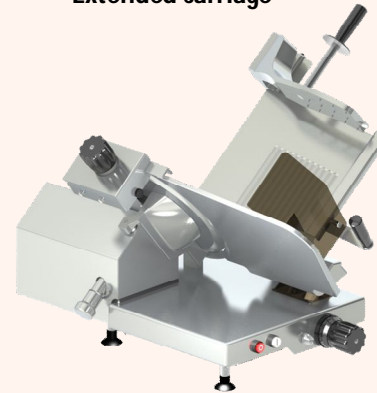

MG - MA
Slicing device

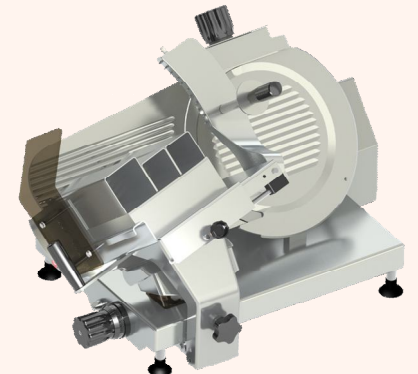

O
P
T
I
O
N
S